

# **ULTRADESK<sup>®</sup>** **LEVEL**



## ASSEMBLY MANUAL

### Precautions:

1. Please pay attention to safety of electric devices, children should use the desk under supervision of adults.
2. Before the product is activated, check if there are any obstacles around the desk.
3. The desk can only be used for home or office and should not be used for other purposes.

### Parts list

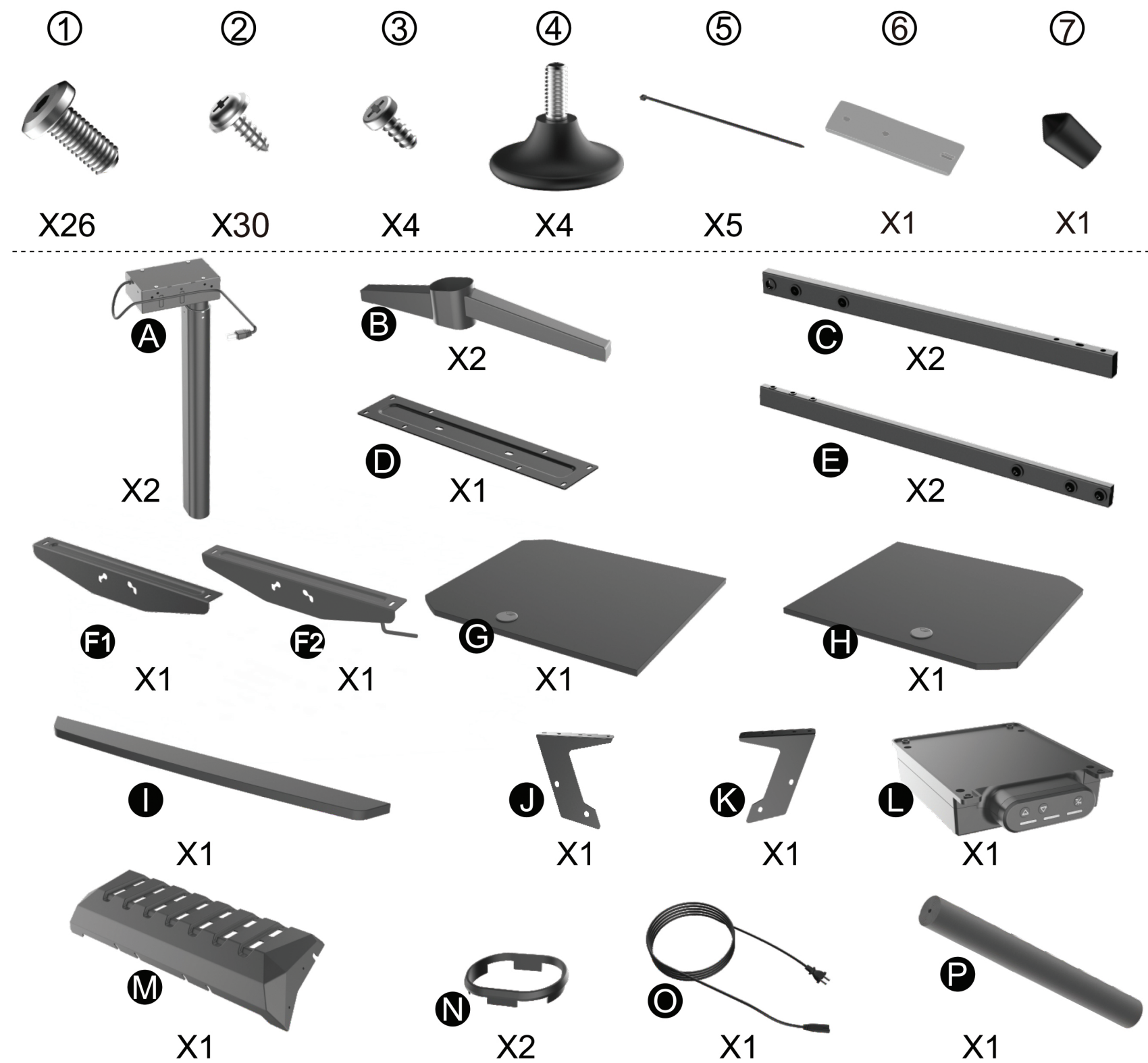

### Step 1

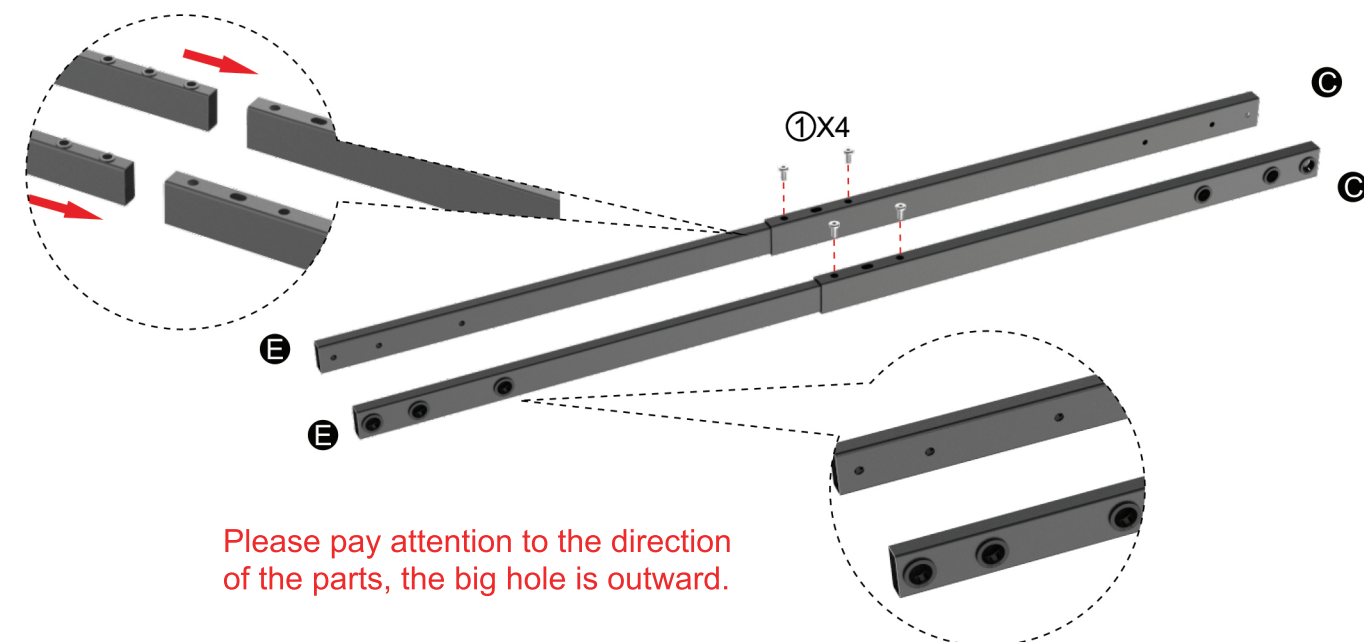



## Step 2

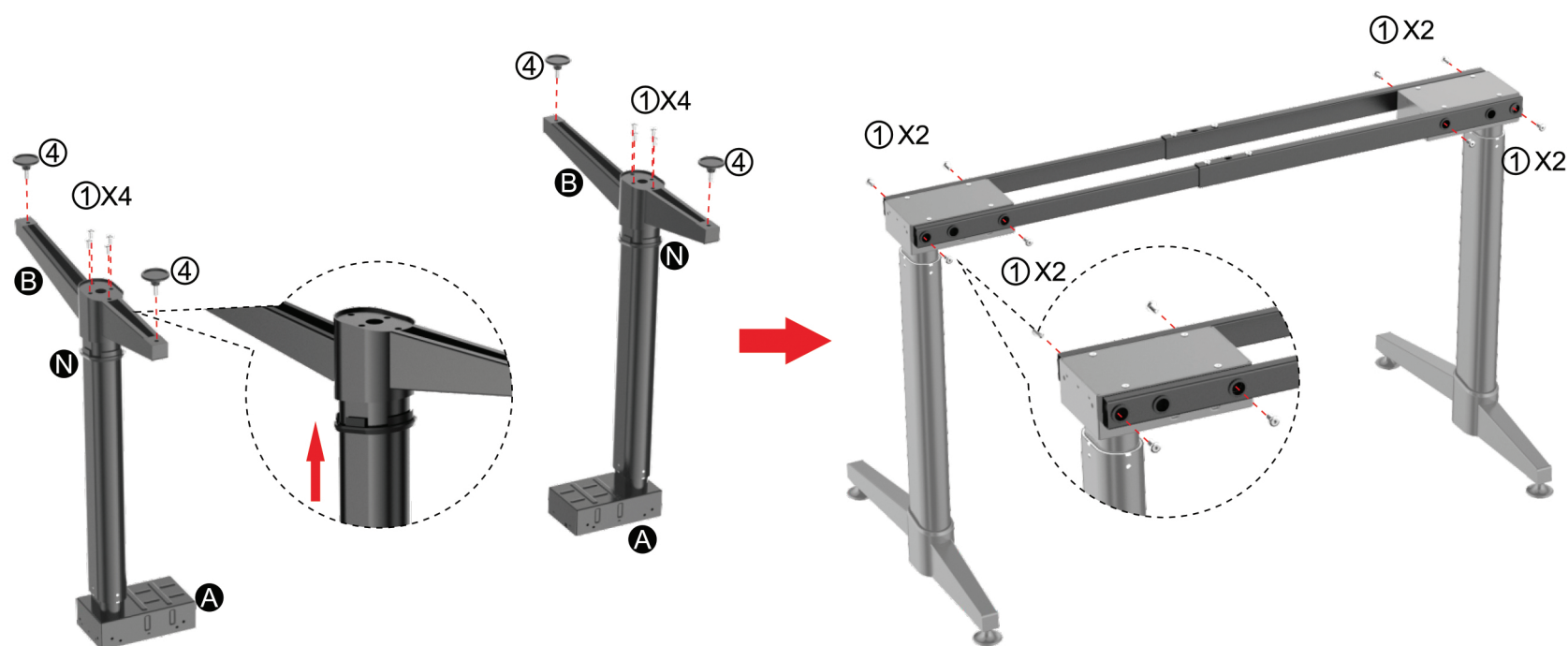

## Step 3

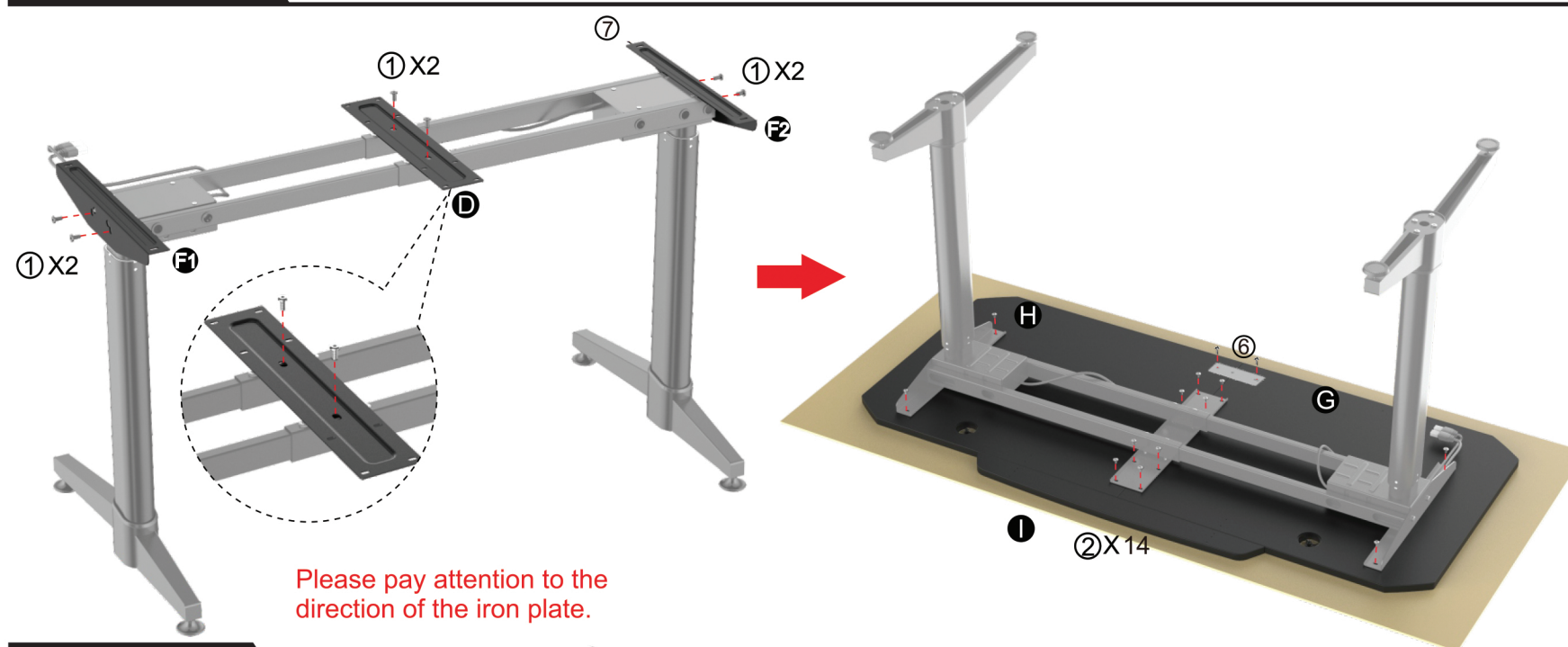

## Step 4

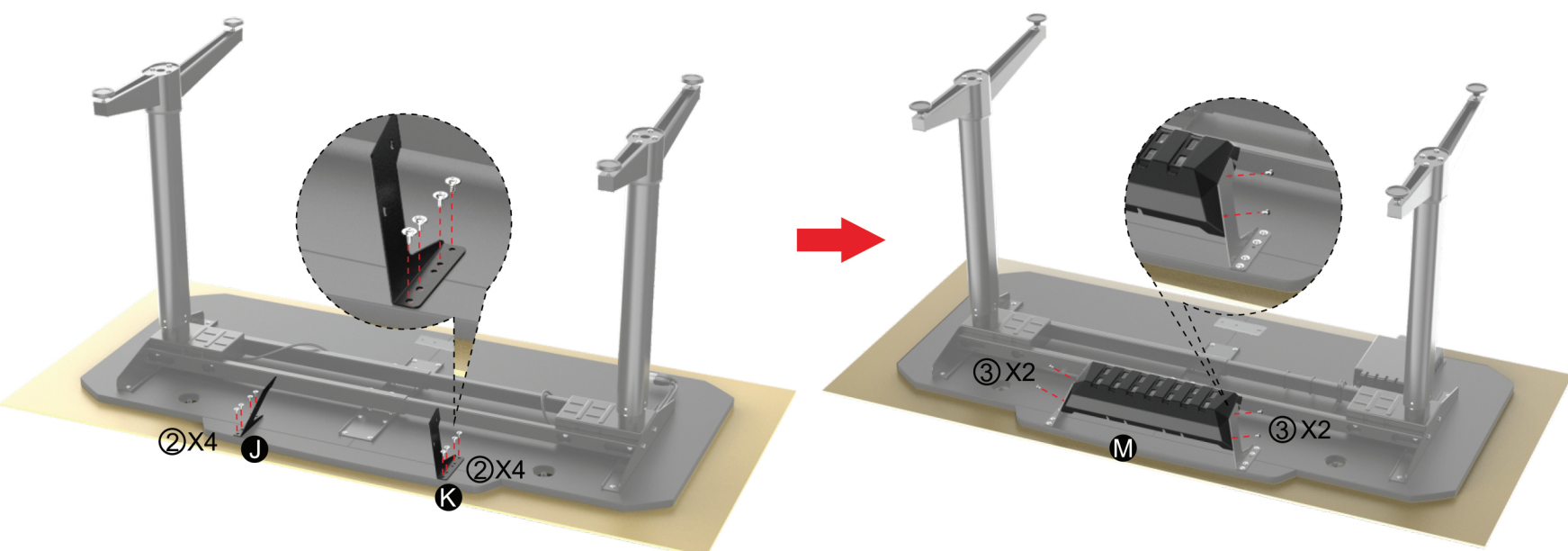

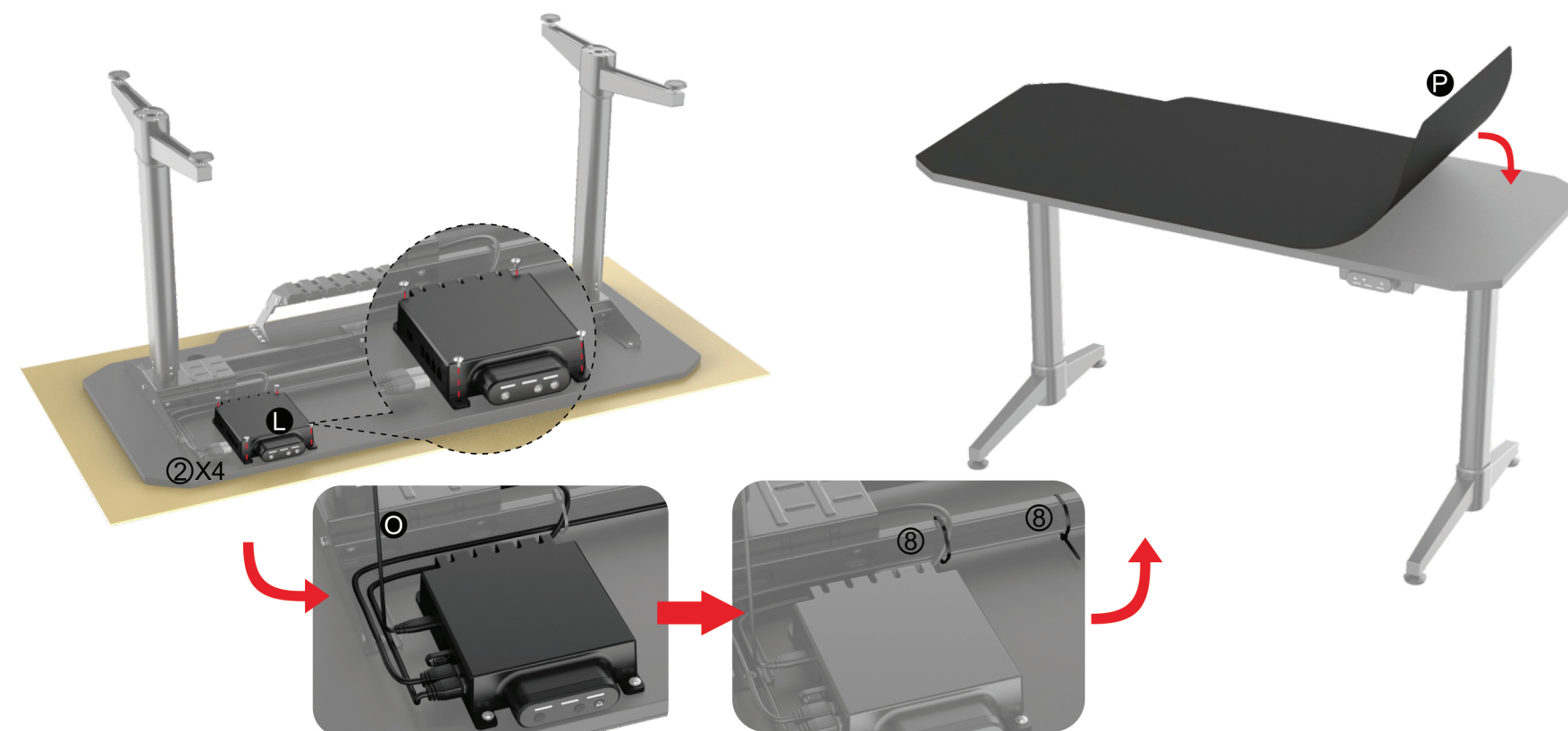

## Step 5



Please use the cable tie to fix the wire.



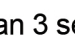
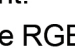



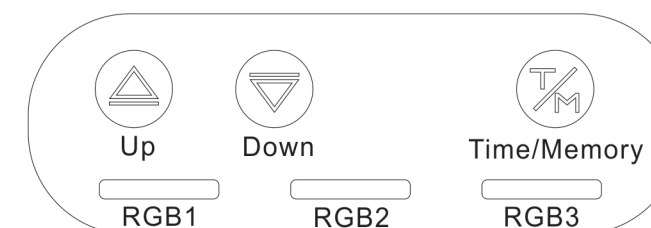

## Instructions

### 1. Product up and down operation.

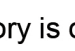
- Press , the RGB1 green light will be on and the table will rise. Press  for more than 3 seconds, the green light flashes, the table will automatically rise to the high memory point.
- Press , the RGB2 green light will be on and the table will drop. Press  for more than 3 seconds, the green light flashes, the table automatically drops to the low memory point.

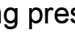



### 2. Height Memory Settings.

- When desk reaches desired height, press  for 3 seconds, RGB3 green light is on, then press the  or  button, RGB3 flashes 5 times and then stops, indicating that the memory is completed.
- The desk through the " + " and " + " combination can remember two heights, one is the high memory point, one is the low memory point; long press  for 3 seconds to reach the high memory point, long press  for 3 seconds to reach the low memory point.

### 3. Sedentary reminder.

- RGB3 with white light means that the time is 30 minutes, light blue light means that the time is 45 minutes, dark blue light means that the time is 60 minutes, the light is off means no timing.
- After the timing is completed, the RGB1+RGB2+RGB3 green light flashes at the same time to remind, press any button to end, enter the next timing.

### 4. Fault retrieval and reset.

- When the new desk is installed, please press the  and the  for 7 seconds. When the RGB1+RGB2 green light flashes, release the buttons and table will automatically run up and down. After the automatic operation is completed, the product can be used normally.
- When the table is not working properly, or when the RGB1+RGB2 red/purple/yellow lights are flashing, please check that all the connecting wires are secure and re-plug all the connecting wires.
- When the second step cannot solve the fault. On the basis of step 2, press the  for 7 seconds, the RGB1+RGB2 green light flashes, release the button, and the table will automatically run to check and repair. After finishing the operation, the product can be used normally.